

# RAIN HARVESTING

by Blue Mountain Co

## First Flush Carrot



### Installation and Specification Guide

#### PRODUCT DETAILS

The Carrot uses the Catch All Tee to prevent dirty water from “skipping” over the First Flush unit and accidentally entering your rainwater tank.

The clever design of The Carrot means that you can install a First Flush device without the need for a traditional chamber. The Carrot resets itself after each rainfall event, giving you hassle-free peace of mind for capturing high-quality rainwater in your tank.

Code	Size	Country
WDDP31	100mm	Australia
WDDP30	90mm	Australia
WDDP230	80mm	New Zealand
WDDP131	4"	USA
WDDP130	3"	USA
WDDP330	80mm	South Africa
WDDP631	75mm 105mm	EU

# Installation

---

## WHAT'S IN THE BOX?

- Catch All Tee
- Carrot housing
- Carrot Upper Collar with O-Ring
- Carrot Lower Slip Coupling
- Filling grommets (A & B)
- Draining grommets (0, 1, 2 & 3)
- Draining wick with grommet
- Wick blanking grommet
- Carrot spring
- Carrot seal
- Carrot flow diffuser
- Carrot
- Carrot filler frame

## TOOLS/MATERIALS YOU MAY REQUIRE

- Tape measure
- Marker pen
- Saw
- Solvent weld glue
- Screws
- Drill or screwdriver

---

## FIRST FLUSH CARROT

1 - Your carrot will come pre assembled out of the box with Filling grommet A installed on the Carrot Filler Frame, and Draining grommet 2 installed on the Carrot. The Wick blanking grommet will be installed as standard. This default setup is a good starting off point to reliably divert an average amount of water with a longer reset time.

2 - Determine the installation location for your Carrot First Flush Diverter. The Catch All Tee can be installed in the horizontal or vertical orientation to suit your installation. Note however that the Carrot Diverter Chamber itself must be installed in a vertical orientation.

3 - Select the orientation of the Catch All Tee appropriate for your chosen installation point. This will determine which socket on the Catch All Tee will attach to your Carrot.

Example: If you're installing your First Flush Carrot into a horizontal pipe, the arrow marking the direction of water flow should be oriented in the direction of flow (see Figure 1b). For installations using the tee in vertical positions, always ensure the arrow is pointed 'up' (see Figure 1a).

4 - Measure your existing downpipe and cut to create space for the Catch All Tee. Ensure all cut edges are clean and smooth. Install your Catch All Tee in place by applying solvent weld glue to the incoming and outgoing sockets and pipe. Leave the lower socket for now. Insert the pipe into the incoming and outgoing sockets at either end of the Catch All Tee.

5 - Apply solvent weld glue to the Carrot Upper Collar and the lower socket of your Catch All Tee and insert it firmly in place.

6 - Make sure the o-ring is located in the groove on the underside of the Upper Collar and screw the Carrot housing into position.

7 - Slide the Carrot Lower Slip Coupling onto the outlet of the Carrot housing and install the remaining pipework as required. Note that the First Flush Carrot will divert the first flush of water down this pipe, so routing this pipework to stormwater or another suitable location is necessary.

8 - We recommend that for the first rainfall event you keep the default Filling and Draining grommets installed (Filling grommet A and Draining grommet 2). Once you have assessed the performance of the Carrot in your rainwater harvesting system, adjust the grommets to suit. Refer to the table in this guide for more information.

Figure 1

### Suggested Installation Orientations

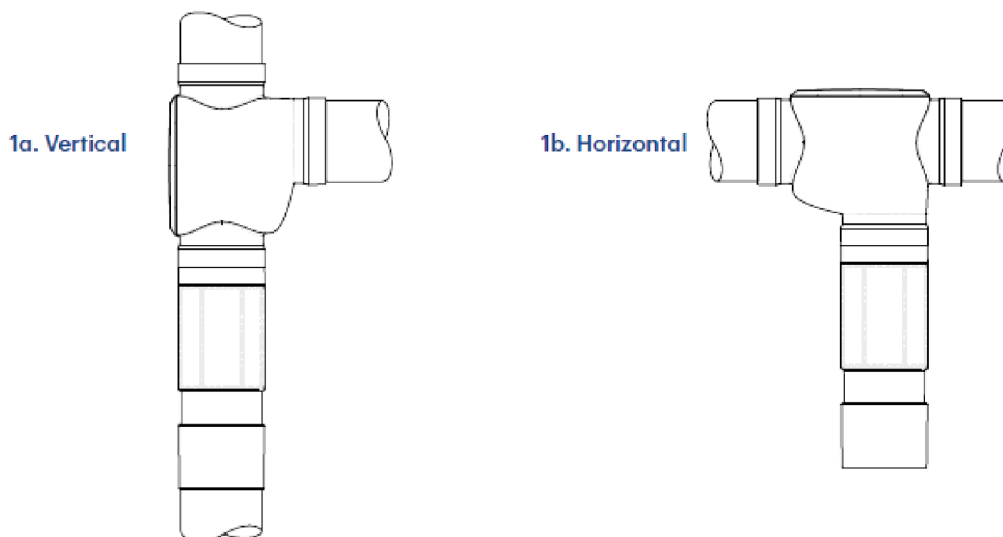

# FLUSHING GUIDELINES

## How to choose your Filling Grommet

### Filling Grommet

**C**

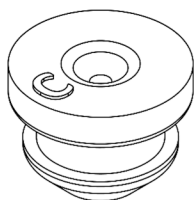

**A**

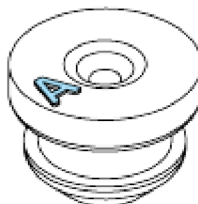

**B**

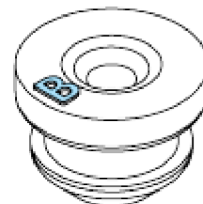

Amount of dirty water diverted

More water diverted

Medium amount water diverted

Less water diverted

## How to choose your Draining Grommet

### Draining Grommet

Wicking Grommet

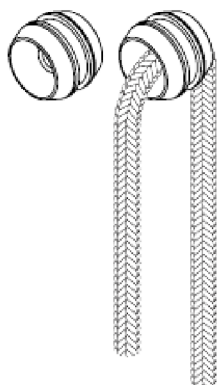

**0**



**1**



**2**



**3**

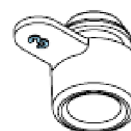

First Flush reset frequency

Longest reset

Long reset

Medium

Quick reset

Amount of dirty water diverted

Least water diverted

Less water diverted

Medium

More water diverted

Maintenance frequency

Most regular maintenance

More regular maintenance

Medium

Less regular maintenance

## Should I choose the Wicking grommet?

If you have very low rainfall intensities, the wicking grommet will provide the longest reset time, ensuring that you capture the most water possible. It will require more maintenance than the draining grommets (which is simple by just washing the wick out occasionally).

### Examples:

- You would use filling grommet B with Draining wick with Draining grommet 0 for very low rainfall intensity where you want to capture as much water as possible
- You would use filling grommet A with Draining grommet 3 for high rainfall intensity on a roof that has high pollution. However this setup would be less suitable for low intensity rainfall as the Carrot may continue to flush water for the entire rain event

### NOTE:

Some combinations of filling grommet and draining grommet are less compatible with typical rainfall events than others.

## REFERENCE CHART

First Flush Carrot  
80mm / 90mm / 3"

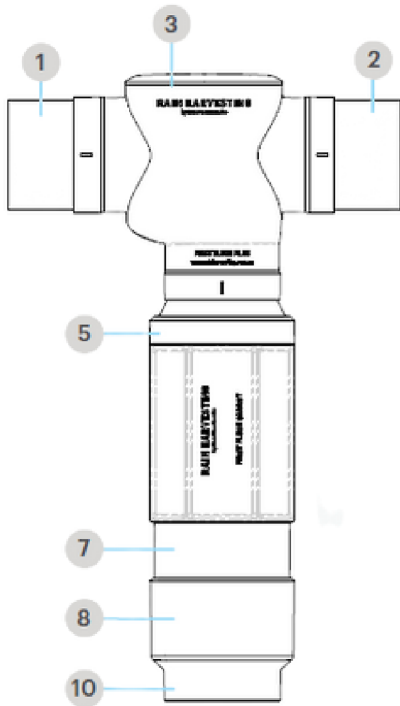

First Flush Carrot  
100mm / 4"

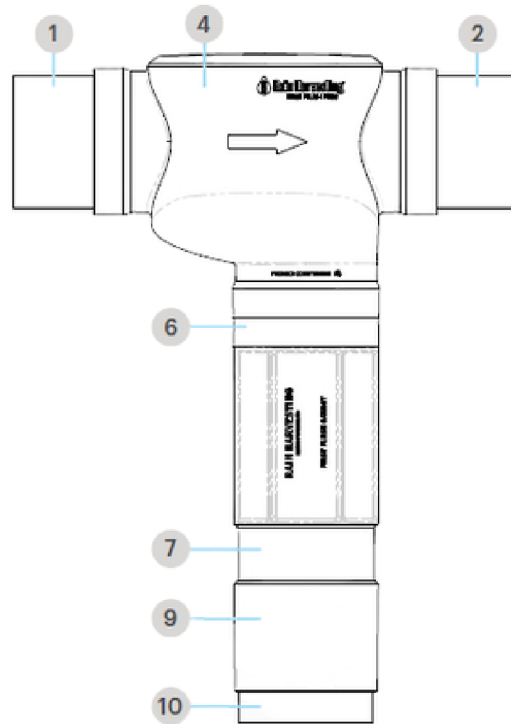

- 1 In-feed from the roof
- 2 To the tank
- 3 90mm Catch All Tee
- 4 100mm Catch All Tee
- 5 90mm Carrot Upper Collar with O-Ring
- 6 100mm Carrot Upper Collar with O-Ring
- 7 Carrot housing
- 8 90mm Carrot Lower Slip Coupling
- 9 100mm Carrot Lower Slip Coupling
- 10 To stormwater
- 11 Carrot Flow Diffuser
- 12 Filling Grommet
- 13 Carrot Filler Frame
- 14 Carrot Seal
- 15 Carrot
- 16 Draining Wick with Grommet
- 17 Wick Blanking Grommet
- 18 Carrot Spring
- 19 Draining Grommets

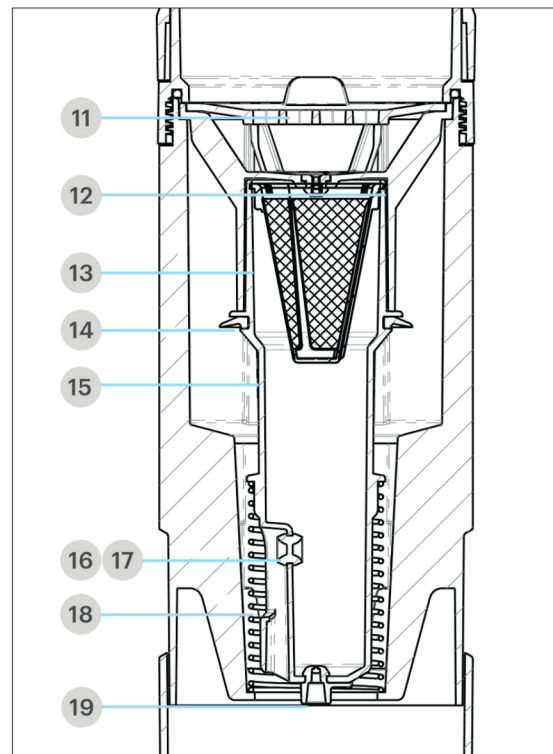

# Product Specifications

## First Flush Carrot

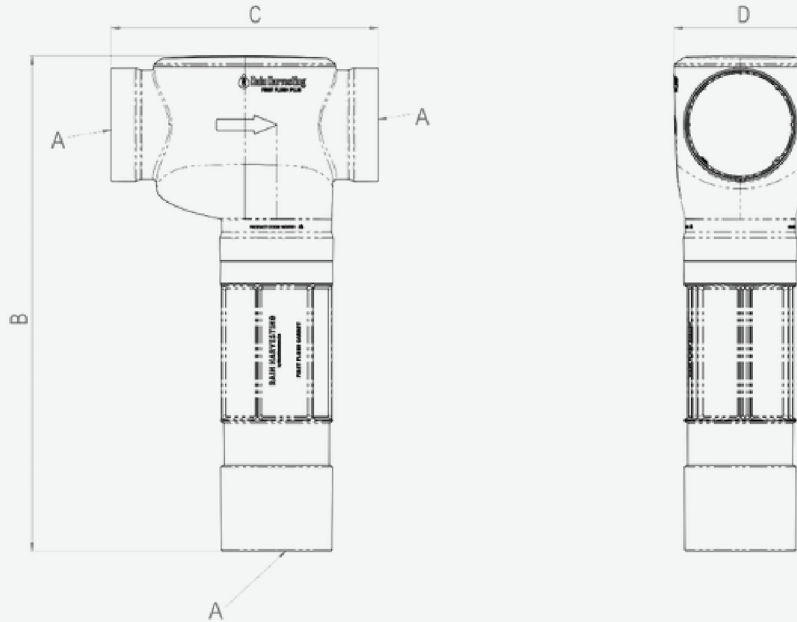

Country	Code	A	B	C	D
Australia	WDDP30	90 F	520	215	120
	WDDP31	100 F	526	283	140
New Zealand	WDDP230	80 F	551	333	140
		100 F	526	283	140
USA	WDDP130	3" SCH40 F / SDR35 F	20.47"	8.62"	4.72"
	WDDP131	4" SCH40 F / SDR35 F	21.61"	11.38"	5.51"
South Africa	WDDP330	80 F	551	333	140
		110 F	526	283	140
EU	WDDP631	75 F	548	327	140
		105 F	526	283	140

All dimensions are in mm unless otherwise stated.

Fitting guide:

F = Female / Socket Fitting

M = Male / Spigot Fitting (Pipe size)

IP = In-Pipe Fitting

# Maintenance

It is important to periodically unscrew the Carrot housing and check the unit is functioning properly. Check that both the Filling Grommet and Draining Grommet have not become blocked. Also check that the spring is functioning correctly and all the internal seals are seated properly.

For best results and minimal maintenance, we recommend installing rain heads such as our Leaf Eater rain heads on all your downpipes to limit the volume and number of leaves and debris that reach your first flush diverter.



A common misconception about collecting rainwater is that all you need is a roof, a tank and some rain. This 'tanking' approach cannot always be relied on to deliver the volume – or quality – of water that you require. That is where we can help.

With some thought, your rain harvesting system can provide you with cleaner water and lots of it. Whether you're completely reliant on tank water or wanting to keep the garden green, our simple steps will help you achieve your goal.

The Rain Harvesting approach to rainwater collection involves using tested and proven products to make quality rainwater available for use in and around your property. You don't need much to get started and you will be surprised how easy it is to get the most out of your rainwater system.

[How can we help you?](#)

**DISCLAIMER** This product specification is not a complete guide to product usage. Further information is available from Rain Harvesting Pty Ltd and from the installation and Operating instructions. This specification sheet must be read in conjunction with the installation and Operating Instructions and all applicable statutory requirement. Product specifications may change without notice. © Rain Harvesting Pty Ltd



# **RAIN HARVESTING**

by Blue Mountain Co

For more information or to find out  
how we can help, just give us a call on

**+61 7 3248 9600**

Or visit our website at

**[rainharvesting.com](http://rainharvesting.com)**